

NORTH[®]

**205102
MV2402**

SLUSH ICE MACHINE

INSTRUCTION MANUAL

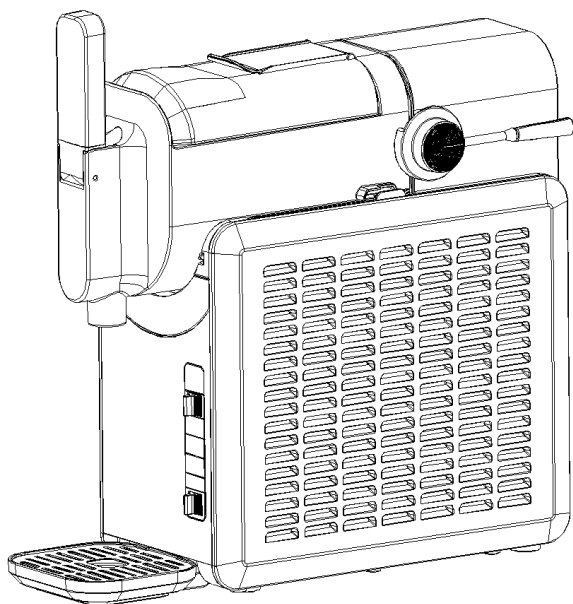

EN DK SE NO FI

THANK YOU FOR CHOOSING OUR SLUSH ICE MACHINE

PLEASE READ THE MANUAL CAREFULLY BEFORE OPERATING

IMPORTANT NOTICES

When using an electrical appliance, basic safety precautions should always be followed to reduce the risk of fire, electric shock, and/or injury, including the following:

1. Before using the slush ice machine for the first time, please wait 2 hours after positioning it, and keep the transparent lid open for at least 2 hours.
2. Read all instructions before using.
3. Remove all packing material and carefully check your slush ice machine to ensure it is in good condition and that there is no damage to machine or power cord and plug.
4. If the supplied cord is damaged, it must be replaced by the manufacturer or its service agent or a similarly qualified person in order to avoid a hazard.
5. Children should be supervised to ensure that they do not play with the appliance.
6. Warning: Keep ventilation openings, clear of obstruction.
7. Warning: Do not damage the refrigerant circuit.
8. WARNING: When positioning the appliance, ensure the supply cord is not trapped or damaged.
9. WARNING : When disposing of the appliance, do so only at an authorized waste disposal center. Do not expose to flame.
10. The refrigerant (R290) is flammable.

Caution: risk of fire / Flammable materials



The refrigerant isobutene (R290) is contained within the refrigerant circuit of the appliance, a natural gas with a high level of environmental compatibility, which is nevertheless flammable. During transportation and installation of the appliance, ensure that none of the components of the refrigerant circuit becomes damaged.

If the refrigerant circuit should be damaged:

- Avoid opening flames and sources of ignition.
 - Thoroughly ventilate the room in which the appliance is situated.
11. Tap water is not recommended to be used on this unit, spring water is

recommended to minimize lime.

12. Ensure the voltage is compliant with the voltage range stated on the rating label and ensure the earthing of the socket is in good condition.
13. To protect against the risk of electric shock, do not pour water on cord, plug and ventilation, do not immerse the appliance in water or any other liquid.
14. Unplug the appliance after using or before cleaning.
15. Keep the appliance 8cm from other objects to ensure good heat releasing.
16. Do not switch on the power button frequently (ensure 5min. interval at least) to avoid the damage of compressor.
17. Do not use outdoors.
18. To avoid contamination of food, please respect the following instructions:
 - Opening the door for long periods can cause a significant increase of the temperature in the compartments of the appliance.
 - Clean regularly surfaces that can come in contact with food and accessible drainage systems.
 - Clean water tanks if they have not been used for 48 h; flush the water system connected to a water supply if water has not been drawn for 5 days.
 - If the refrigerating appliance is left empty for long periods, switch off, defrost, clean, dry, and leave the door open to prevent mold developing within the appliance.
19. Regarding the information pertaining to the use of the appliance, please refer to the paragraphs below.
20. Do not put your fingers into the discharge opening as this may cause danger.

SPECIFICATIONS

Model Number: 205102

Effective volume: 2L (using volume: 1.42L)

Voltage: AC220-240V / 50 Hz

Power Consumption: 220 W

Rated current : 1.4A

Protection against electric shock: I

Climate Type: N/SN

FEATURE

1. Touch buttons, LED display, toggle adjustment switch, simple operation, reliable, convenient and worry-free.
2. The thickness of the beverage can be adjusted
3. There are five types of beverage Slush Ice production modes plus cleaning mode.
4. The parts are detachable, easy to clean, hygienic and safe.

PRODUCT INSTRUCTION

1) Structure

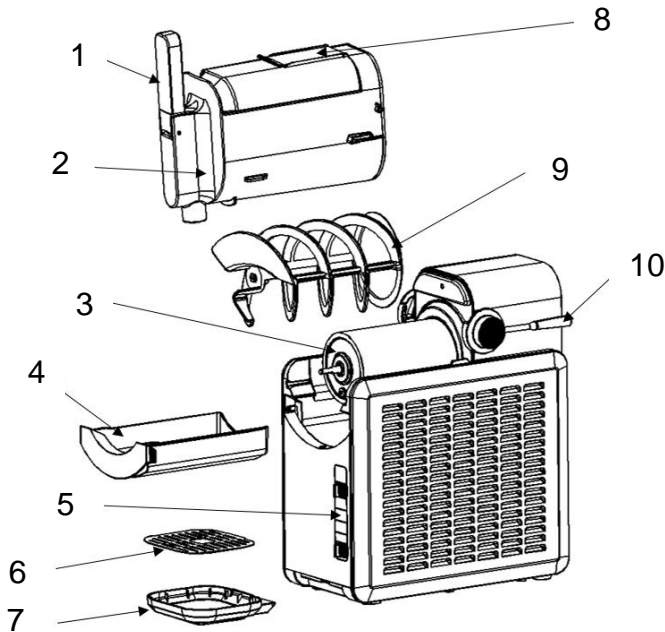

- | | |
|-------------------|---------------------------|
| 1. Handle | 6. Decorative plate |
| 2. Feeding barrel | 7. Water tray |
| 3. Main housing | 8. Feeding barrel top lid |

4. Water tank
5. Control panel

9. Stirring blades
10. Locked barrel switch

2) Control panel

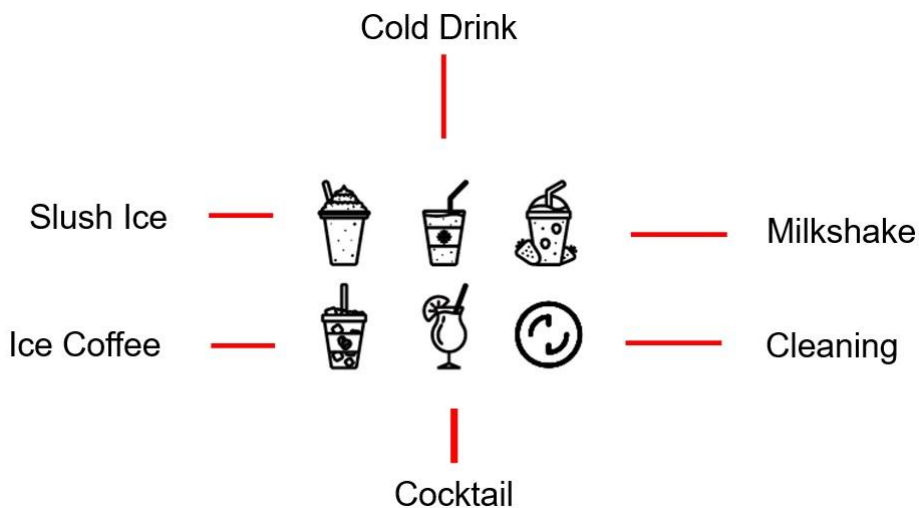
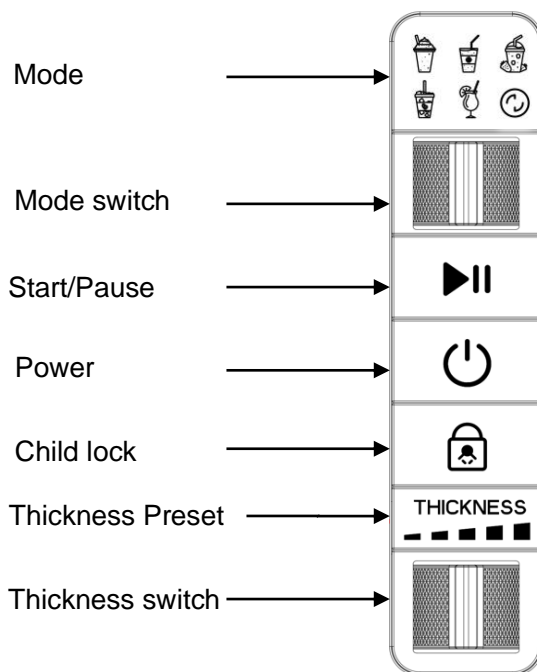

OPERATION INSTRUCTION

NOTE: Before use, please thoroughly wash and wipe off all components that come into contact with liquid, including evaporator, loading barrel, mixing blade, etc. Before cleaning, it is necessary to ensure that the power cord plug is disconnected from the socket. When using the machine, please keep it flat on a horizontal surface to ensure that the compressor of the machine is working properly.

a. Please install the handle and water tray when using it for the first time, as shown in the figure:

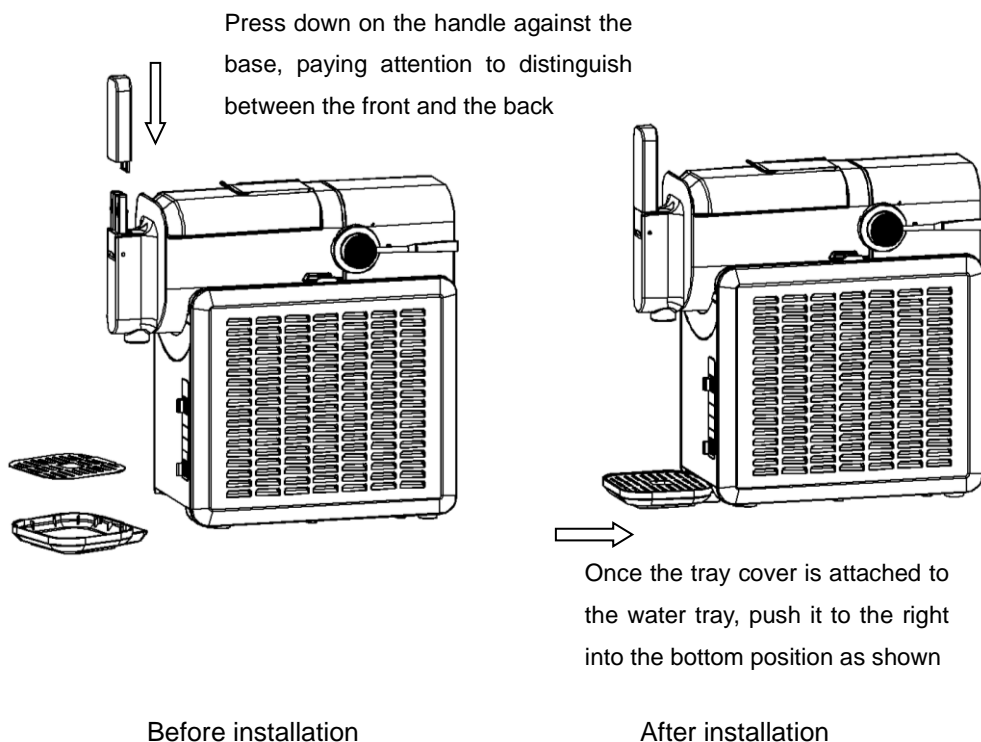

b. Before discharging and operation, the mixing fan blade and the charging barrel must be packed and locked, as shown in the figure:

The open state of the
charging barrel switch

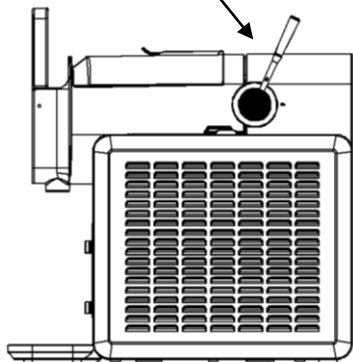

Before installation

The open state when the charging
barrel switch is locked

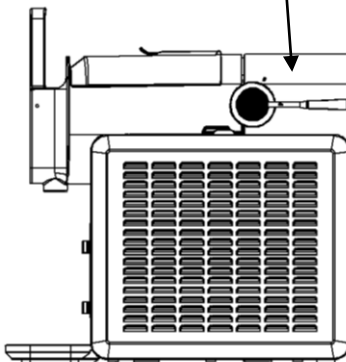

After installation

OPERATION STEPS

1. Check the charging barrel before pouring the material into the charging barrel to ensure that the charging barrel is installed in place (see the "cleaning" part for the disassembly and assembly steps, please install the discharge handle and water receiving tray before using it for the first time), open the top cover of the charging barrel, and then slowly pour the material into the charging barrel (as shown in Figure 1), and the liquid capacity should be between the Minimum and Max water levels (as shown in Figure 2).

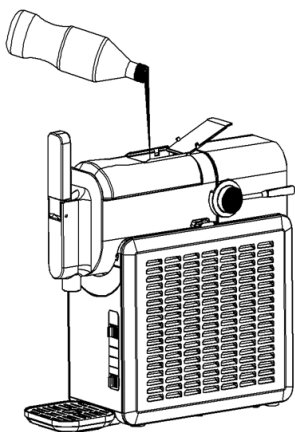

Figure 1

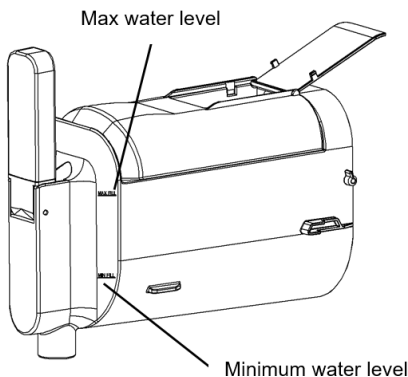

Figure 2

2. Then close the top lid of the charging barrel.

3. Plug in the power supply, touch the power switch icon and the machine will turn on, the default slush ice mode will be turned on for the first time, and the mode used last time will be automatically selected if it is not used for the first time (see Figure 3 for the mode description), the selected mode icon flashes, and the left or right toggle function to select the switchable mode. Toggle the thickness left and right to adjust the thickness of the slush ice, and the thickness indicator has a total of 5 bars, the more grids mean the lower the temperature of the Slush Ice after it is formed. Each toggle increases or decreases by one bar, the default 3 bars are used for the first time, and the last mode used will be automatically selected for non-first-time use. Touch the start/pause icon once, the machine will start working, only the selected mode icon flashes, at the same time, the child lock function is automatically enabled, the child lock icon indicator light is on, and the machine cannot be operated at this time. Long touch the child lock icon to turn off the child lock function, the indicator light at the child lock icon will be off, and the machine can be operated at this time. Touch the start / pause icon to pause or start the machine. Touch the power switch icon to power off.

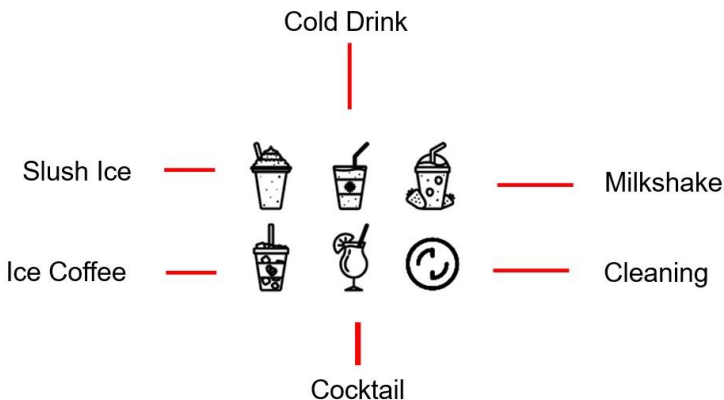

Figure 3

4. After the Slush Ice is ready, there will be 6 short beeps, and the function icon will not flash at this time. The machine enters the heat preservation state, and the

machine is kept at the set temperature for cyclic work. At this time, put the cup under the discharge port, press the discharge handle, and enjoy the Slush Ice.

5. After 4 hours of heat preservation, the machine returns to the mode selection state, and the machine returns to standby state after 10 minutes without any operation.

6. Cleaning the machine: After the Slush Ice is finished, you can touch the power switch icon to turn it off. To clean the machine, pour clean water into the charging bucket to the maximum water level, pay attention to the water temperature should not exceed 50 degrees Celsius or 122 degrees Fahrenheit, and select the cleaning mode after turning on the machine to clean the machine. For details about the cleaning mode, see Step 3, and the cleaning time is 4 minutes by default. After cleaning, clean the water in the bucket. If a single wash does not bring the drum back to clean, repeat the operation. The barrel can be removed for thorough cleaning, as described in the "Cleaning" section.

PROTECTION FUNCTION

a. Motor protection function: During the working process of the machine, in order to prevent the stalling of the stirring motor due to the Slush Ice becoming harder and harder, the software in machine will monitor the working state and automatically stop the motor when necessary to ensure the service life of the stirring motor.

b. Compressor protection function: In order to prevent the compressor from starting frequently, during the refrigeration process, if the compressor is turned on within less than 3 minutes after working, the compressor may have about 3 minutes of protection time. However, if you unplug the power cord for 20 seconds and then plug it in, and then start the machine, it will start again by default and there is no delay.

c. Charging barrel assembly falling off protection device: In order to prevent the operation of the compressor and stirring motor from abnormally or causing injury to the human body after the charging barrel falls off or takes out, the charging barrel assembly has a contact switch with the main body of the machine, and the machine cannot be started and the mode display light flashes after the charging barrel assembly falls off or is taken out.

TIPS

1. In order to avoid increased mixing load and overflow after ingredients expansion, the ingredients should not exceed the maximum capacity water level. For accurate temperature control and normal operation, the ingredients needs to be added to the minimum capacity water level (see Figure 2).
2. The completion time of machine work varies due to various factors such as environmental temperature, initial ingredients temperature, sugar content, and soft hardness adjustment.
3. The Brix (percentage of sugar content) of the ingredient's mixture produced must be greater than 6, Alcohol content must be in the range of 2% to 16%, otherwise do not use the machine. If used, it may cause the evaporator to freeze, the stirring blades to scratch, and damage the machine.
4. Pouring the pre cooled ingredients into the loading barrel can further improve the production efficiency.
5. If you use natural fruit juices, it is recommended to filter them to prevent the solid parts contained in them from blocking the discharge of the faucet.
6. When making sorbet, do not stop the mixing motor, as it may cause the mixing to fail when the liquid solidifies or freezes before restarting.
7. Condensation on the outside of the charging drum is normal in wet weather or during long working hours.

CLEANING

Disassemble

Pour in clean tap water before disassembly, start the cleaning mode for about 2-3 minutes, and then drain the liquid in the filling bucket.

1. Unplug the power connection, turn the charging barrel switch to the unlocking position (as shown in Figure 4), remove the charging barrel, and then take out the mixing fan blade to clean it and dry it with a towel.
2. Pull out the water tray, pour out the liquid inside, clean it and dry it with a towel.
3. Wipe the evaporator and the rear sealing ring with a clean towel. Note that the sealing ring cannot be disassembled, nor can it be pulled forcefully, so as not to cause water leakage due to its deformation and cause the machine to be

scrapped.

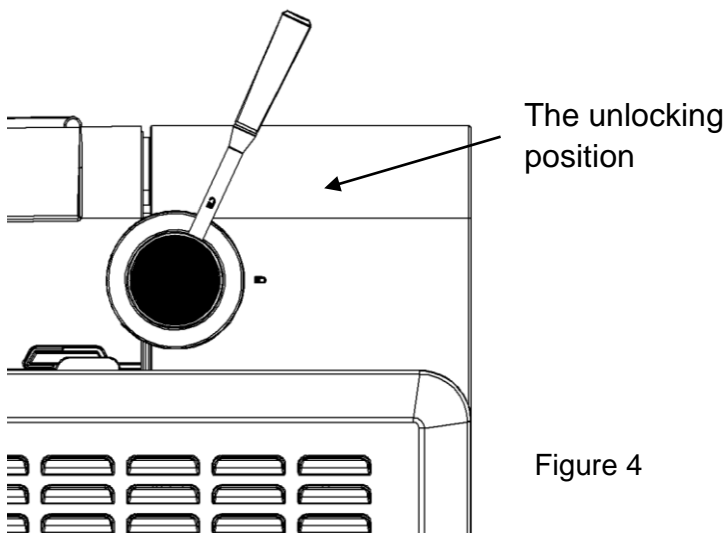

Figure 4

The filling bucket, mixing fan blades and water box are all dishwasher safe and hand washed as follows:

1. Prepare about 8L of warm water (about 40-50 degrees) and a cleaning solution in a basin.
2. Use a suitable brush and thoroughly wash all parts that come into contact with the material with a cleaning solution.
3. Rinse all cleaned parts with running water.
4. Use a soft brush to clean the sealing ring at the rear of the evaporator cylinder.
5. Finally, wipe the surface of the cleaned parts with a dry towel or air.

MAINTENANCE

Caution: The plug must be removed before cleaning to avoid electric shock.

1. Clean the water tank components, sealing rings, etc. in a timely manner after use to avoid odor.
2. Take out the removable bowl, clean it with a dampened soft cloth.
3. Wipe the transparent lid with a dampened cloth. Remove the dirty on the body or other places with a dampened cloth, and do not pour water on cord, plug and ventilation, immerse the appliance in water or any other liquid

4. Allow drying thoroughly with a dry cloth, then return the component to the home position.

COMMON PROBLEM & SOLUTIONS

No.	Problem	Reason analysis	Resolutions
1	All icons and thickness bar light up and flash	Poor contact between the charging drum assembly and the micro switch;	Inspect the barrel assembly to make sure it is installed correctly and lock the barrel switch.
2	The stirring fan blades crackled	The low sugar content of the materials used causes the evaporator to freeze, or the setting temperature is too low and the Slush Ice is too hard	Use ingredients with a higher sugar content instead
3	The stirring fan blades crackled	Check that the stirring fan blades are properly assembled or deformed	Properly assemble the stirring fan blades
4	The stirring fan blades crackled	The stirring fan blades are deformed	Replace the stirring fan blades with new ones

AFTER SALES SERVICE

The following conditions is not covered by the warranty:

- 1) Components are damaged due to improper use, maintenance and storage;
- 2) Damage caused by non-NORTH maintenance personnel or designated personnel to disassemble the product by themselves.
- 3) No purchase invoice or purchase invoice does not match the product;

If you experience quality problems, please contact the service center. Do not disassemble it yourself. The company will not bear any responsibility for quality problems or accidents caused by self-disassembly.

PARTS

Water tray box	1	User manual	1
Water tray box cover	1	Handle assembly	1 set



This marking indicates that this product should not be disposed of with other household wastes throughout the EU. To prevent possible harm to the environment or human health from uncontrolled waste disposal, recycle it responsibly to promote the sustainable reuse of material resources. To return your used device, please use the return and collection systems or contact the retailer where the product was purchased. They can take this product for environmentally safe recycling.

Illustrations may differ from actual product. We are constantly striving to improve our products, therefore the specifications contained herein are subject to change without notice.

Smart Trade ApS
Rudolfgaardsvej 8
DK-8260 Viby J
Smart-Trade.dk

Funnivation HK Ltd.
Unit 03-04, 21/F
Eight Commercial Tower,
8 Sun Yip Street, Chai
Wan, Hong Kong

